

HEYE

I N T E R N A T I O N A L

A member of the ardagh group

Heye Servo Technology for IS-Machines

presented by :

Dipl.-Ing. Hans-Joachim Böer
AFGM Conference, Manila 2006

Heye Servo IS-Machine

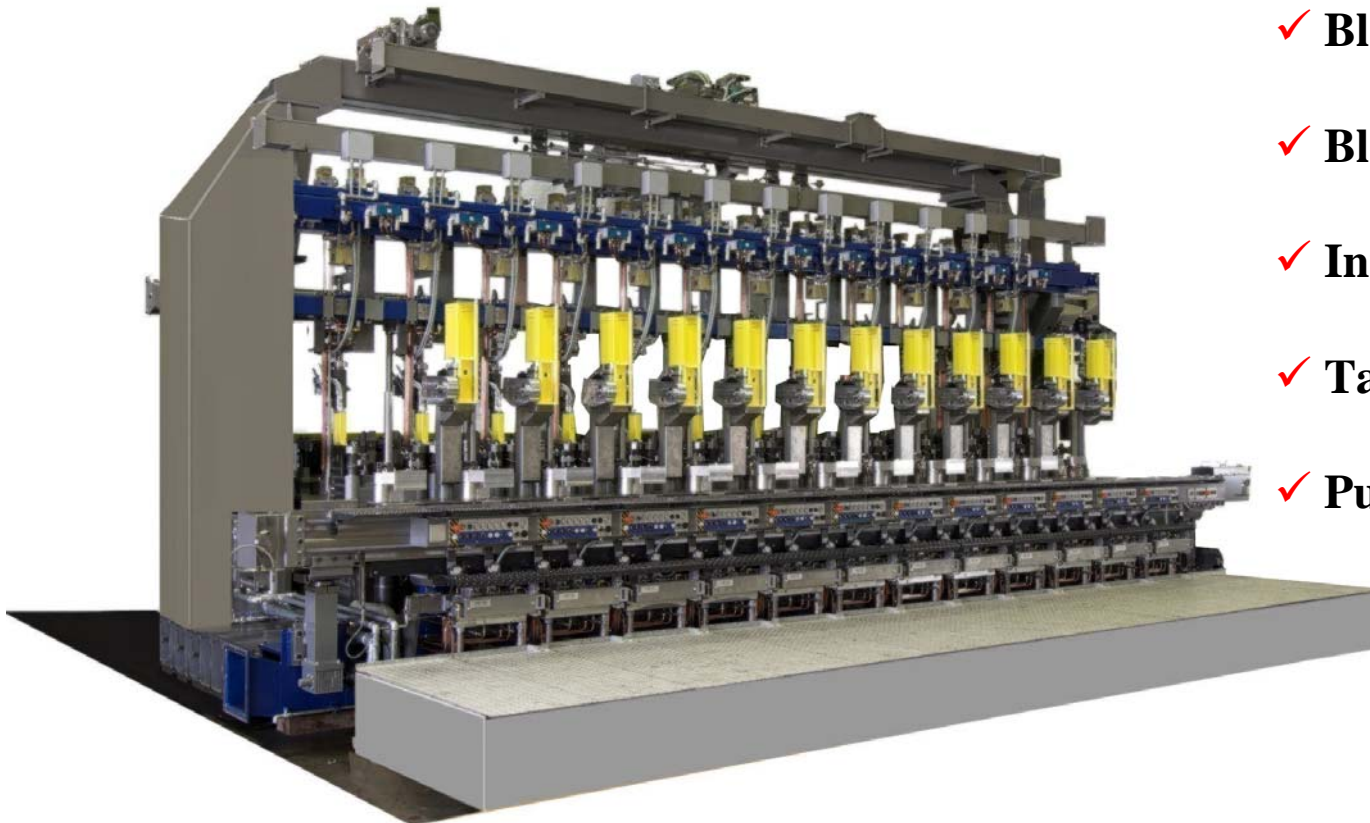

**The following Servo Mechanism
are installed :**

- ✓ **Blank Mould Closing Mechanism**
- ✓ **Blow Mould Closing Mechanism**
- ✓ **Invert Mechanism**
- ✓ **Take Out Mechanism**
- ✓ **Pusher Mechanism**

Servo IS-Box 6 1/4" DG

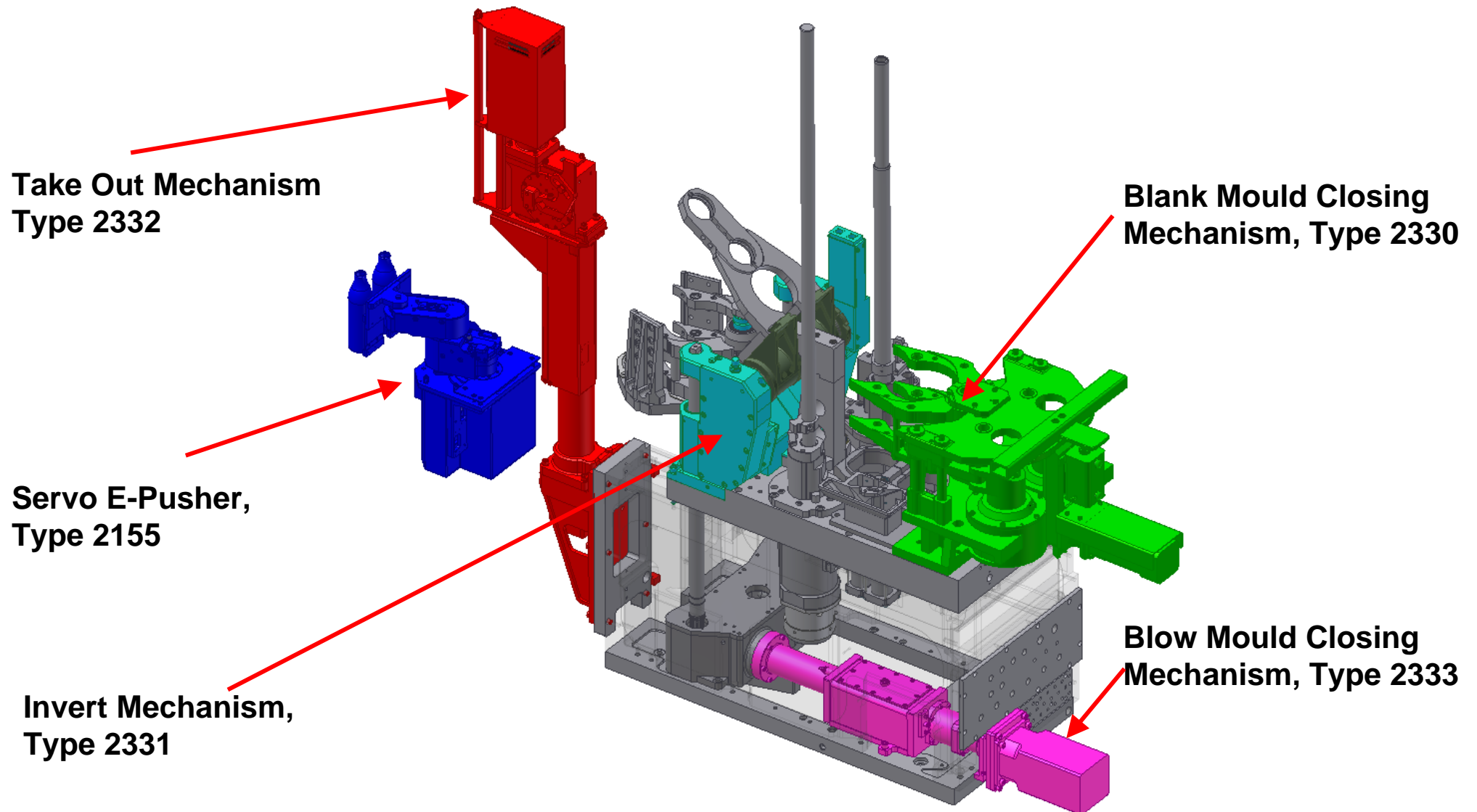

Blank Mould Closing Mechanism, type 2330

Advantages

- Harmonic motion profile
- Preselectable motion profile
- Closing forces more than 12 kN
- Symmetry of forces and motions
- Center axis kept even after wear
- Parameter setting via dialog

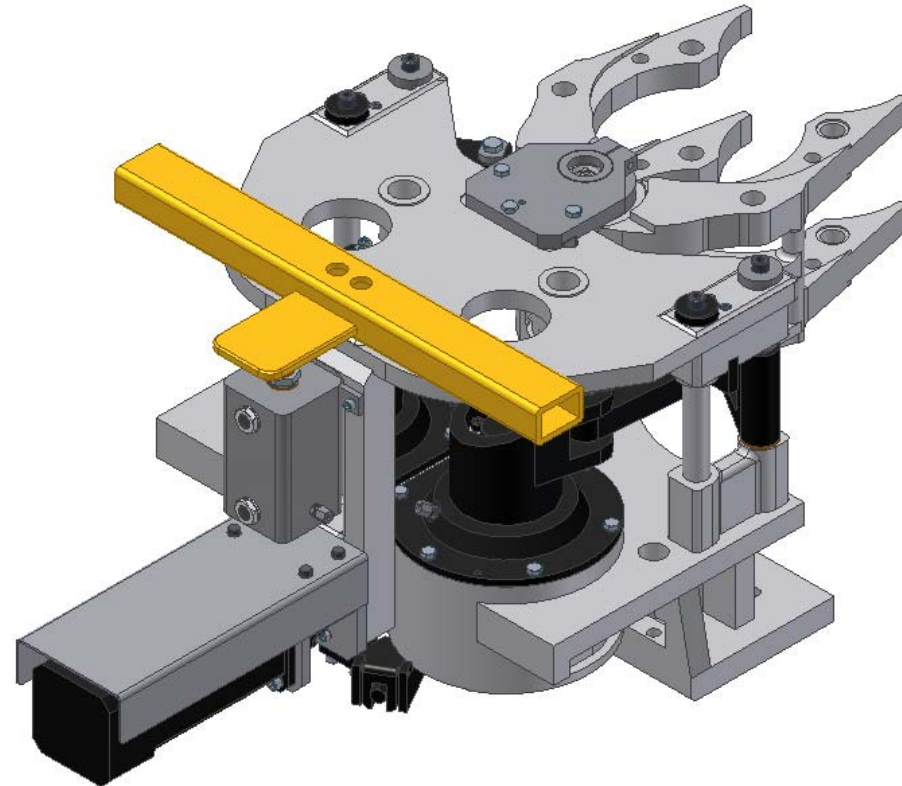

Blank Mould Closing Mechanism, type 2330

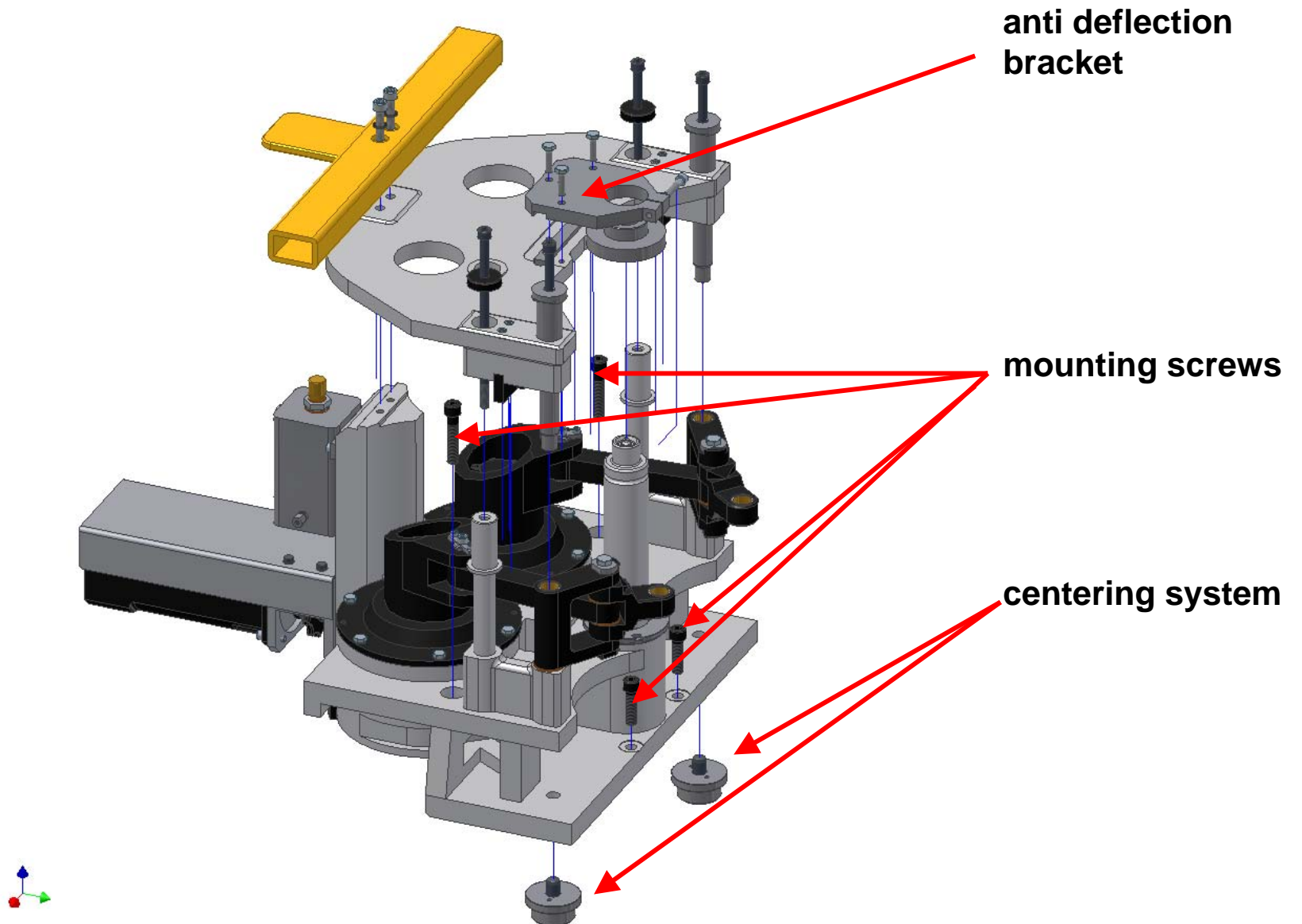

Blank Mould Closing Mechanism, type 2330

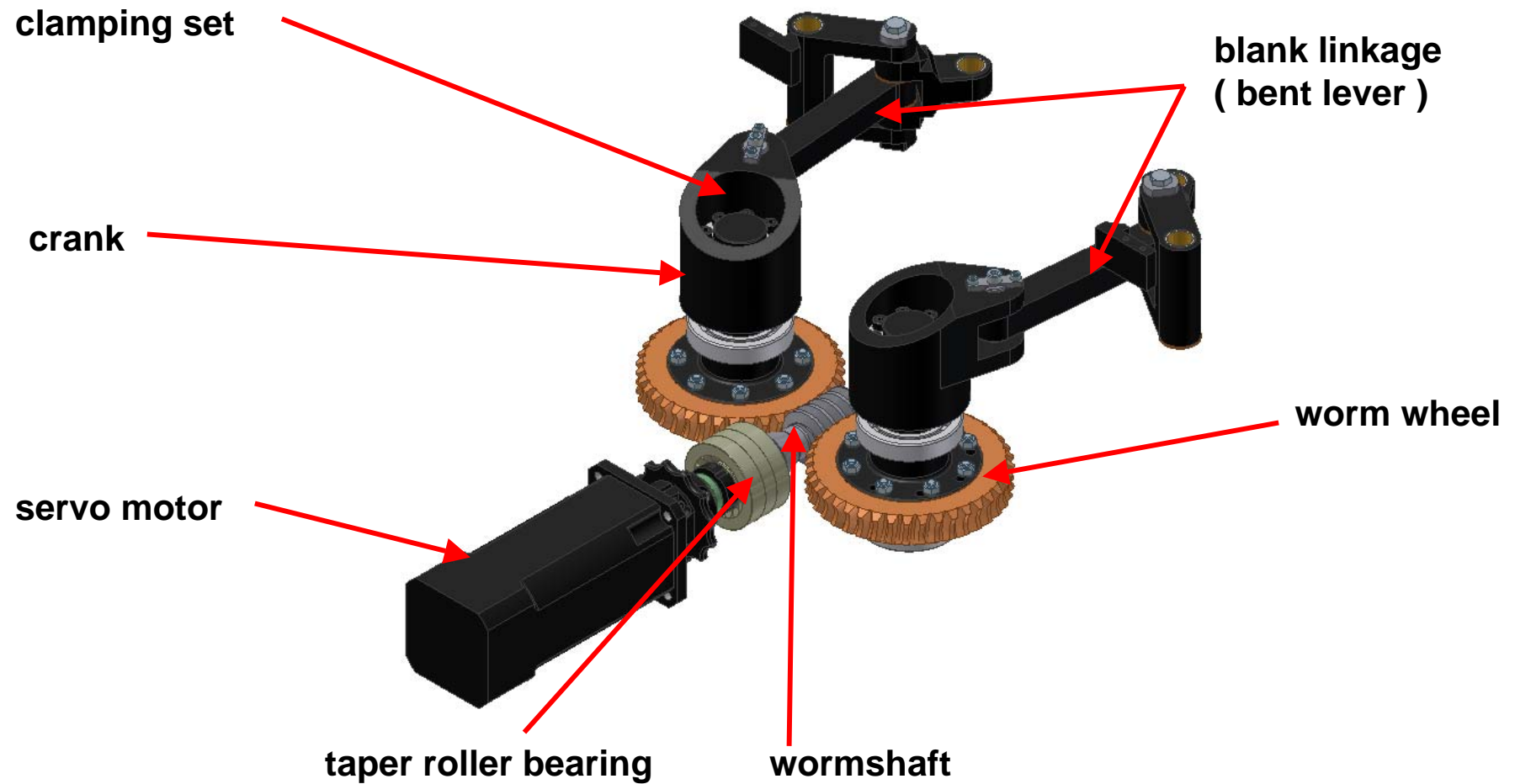

Blow Mould Closing Mechanism, type 2330

Advantages

- Harmonic motion profile
- Preselectable motion profile
- Closing forces up to 9 KN
- Parameter setting via dialog
- Preselectable opening angle according to container dia.

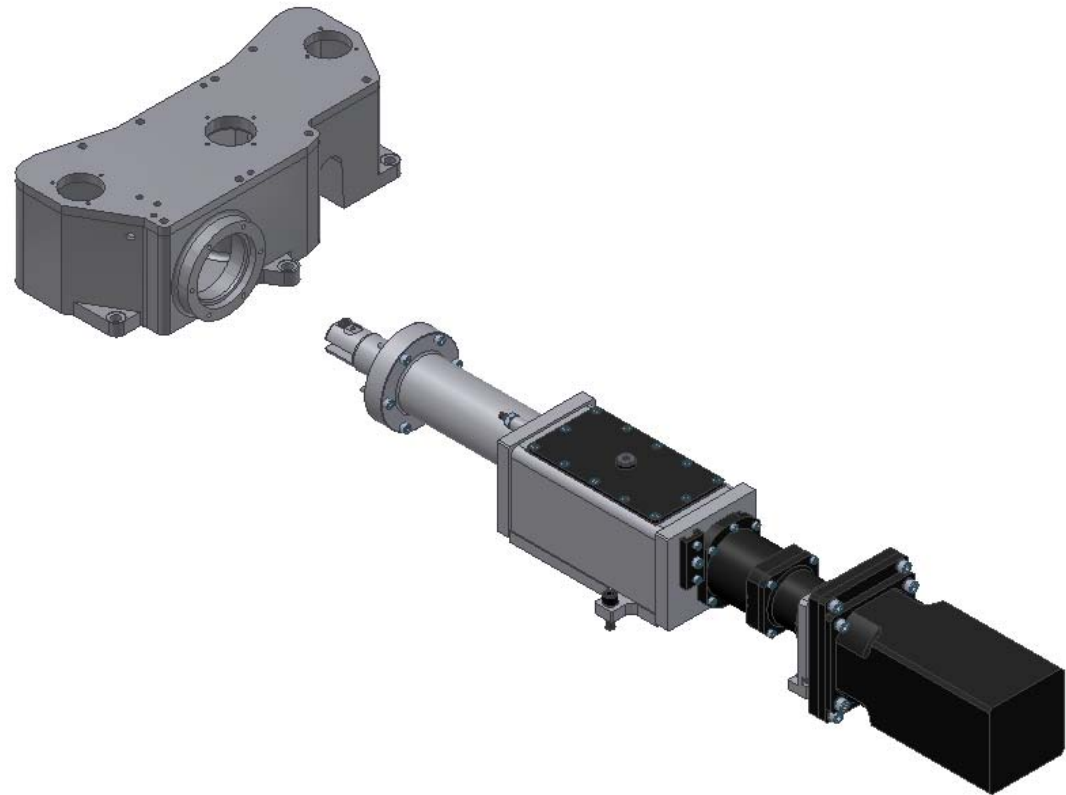

Blow Mould Closing Mechanism, type 2330

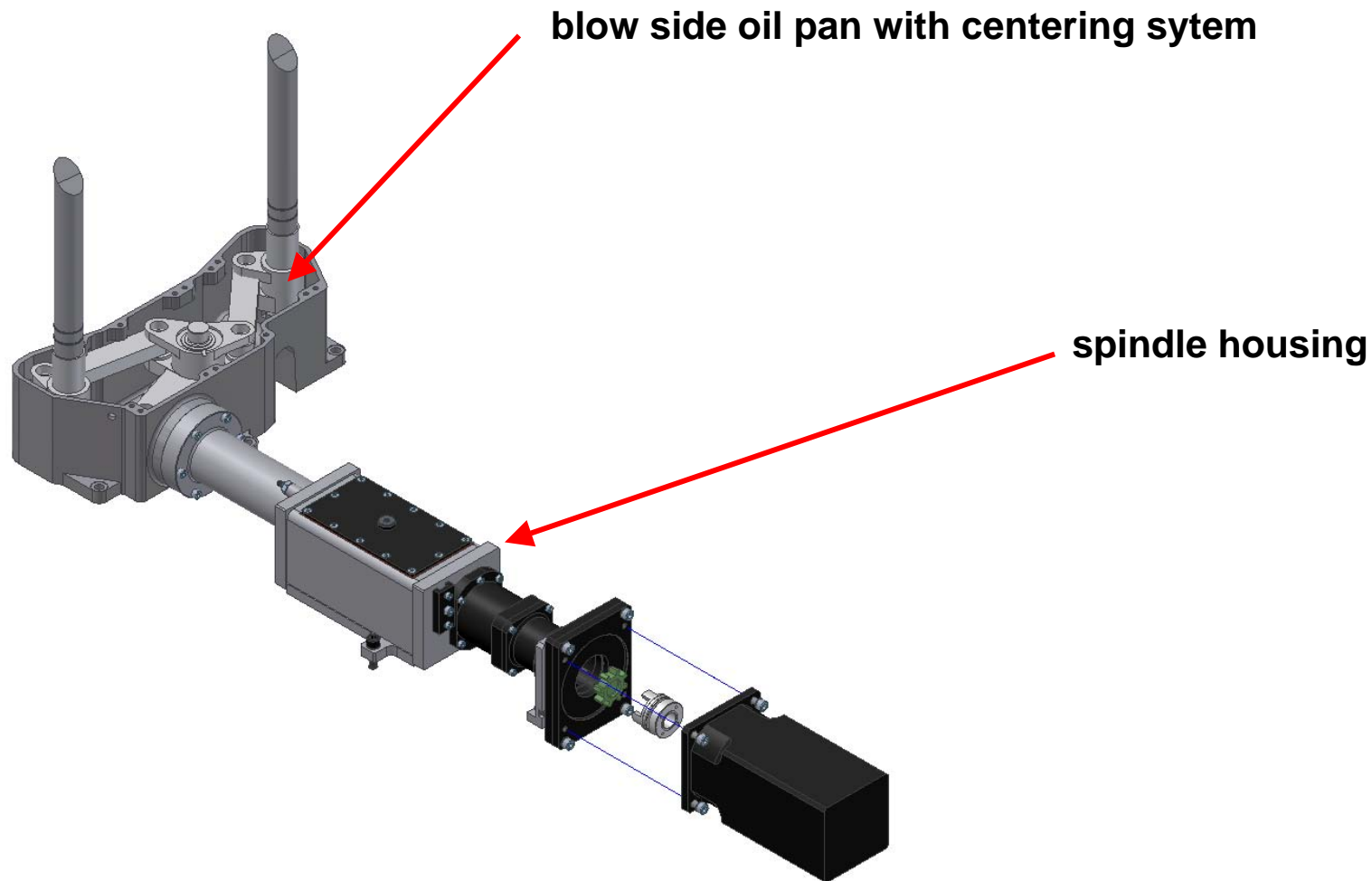

Blow Mould Closing Mechanism, type 2330

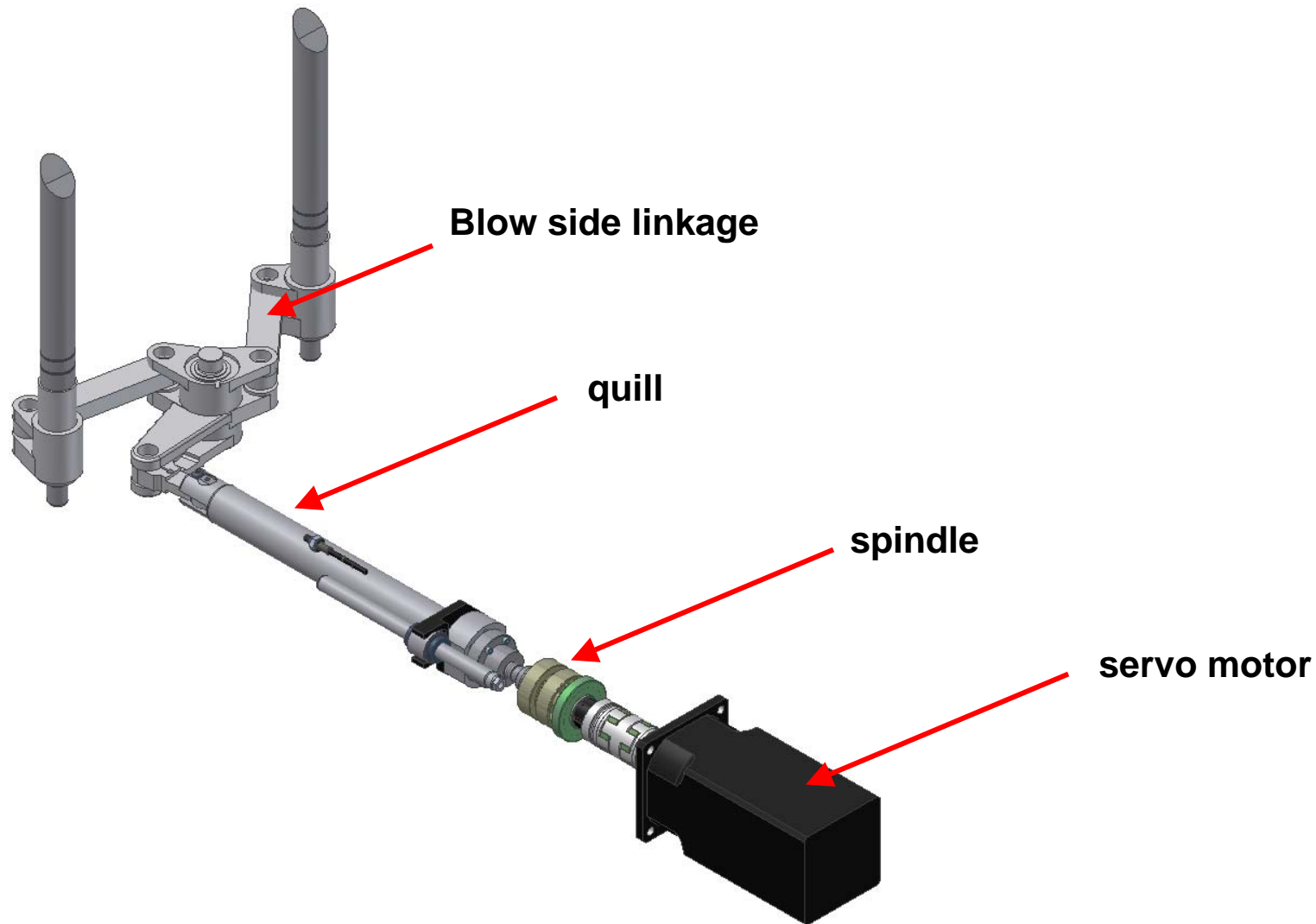

Invert Mechanism, type 2331

Advantages

- Single, double and triple gob operation
4 ¼" to 6 ¼" center distance
- easy exess to the servo motor
- Preselectable motion profile
- Synchronized opening of both
neck ring holder arms
- Parameter setting via dialog

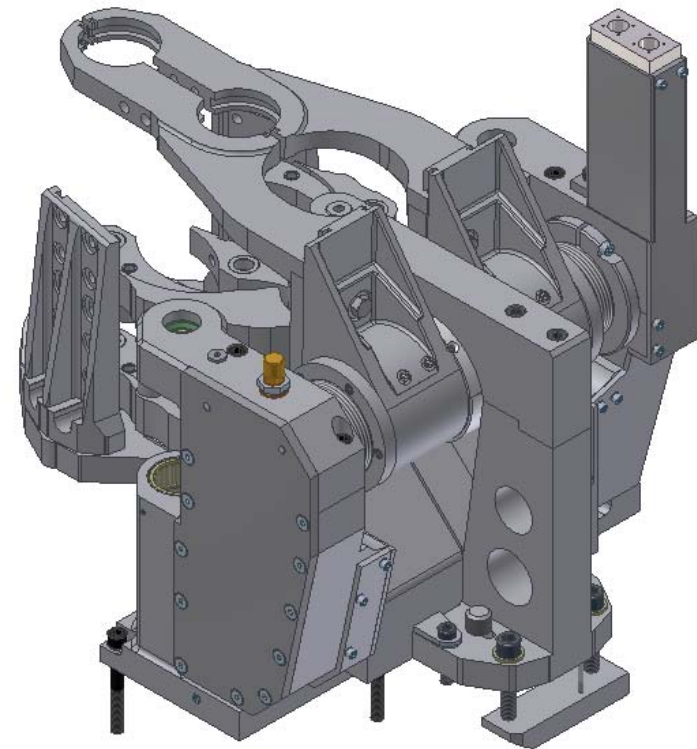

Invert Mechanism, type 2331

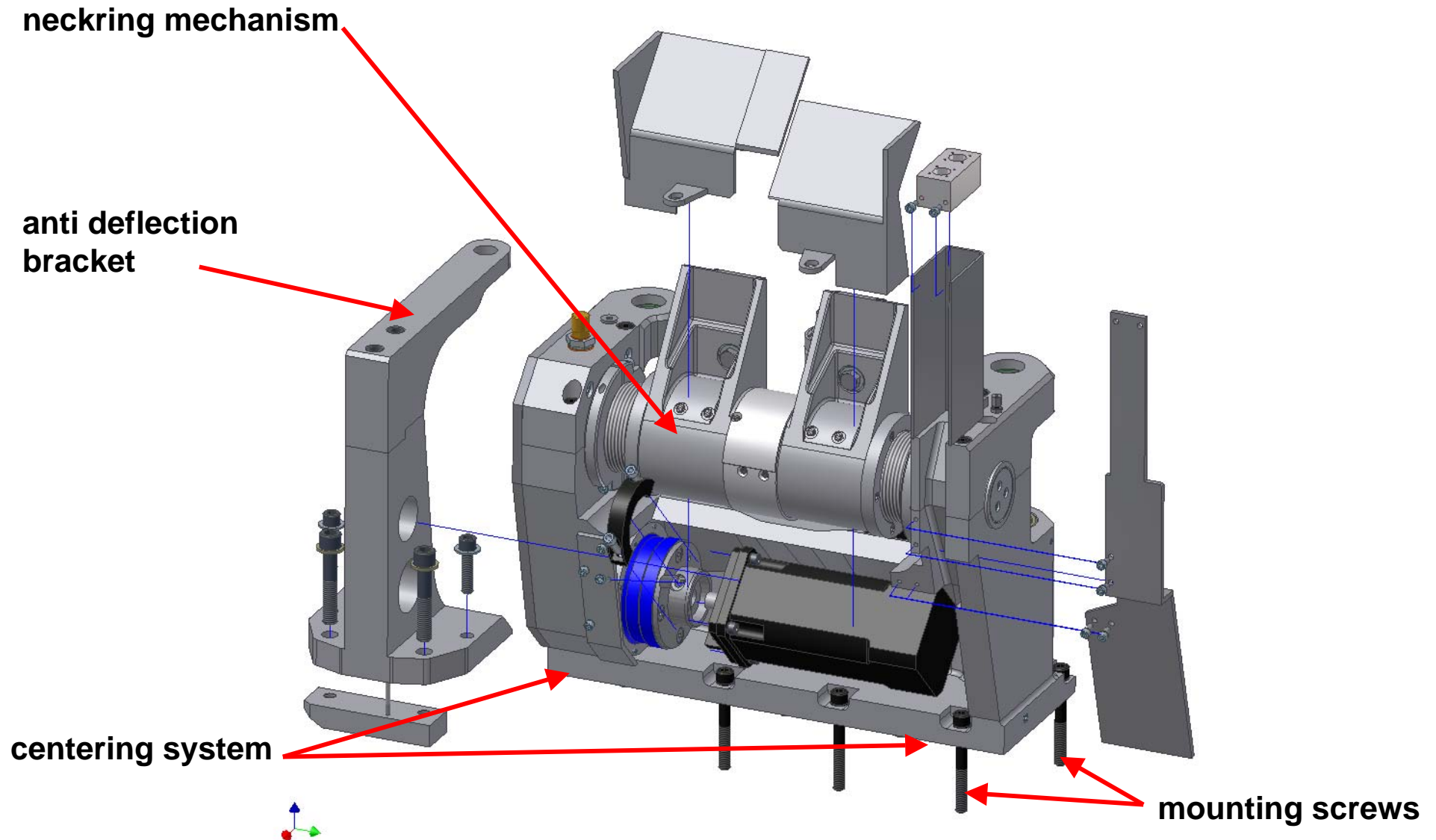

Invert Mechanism, type 2331

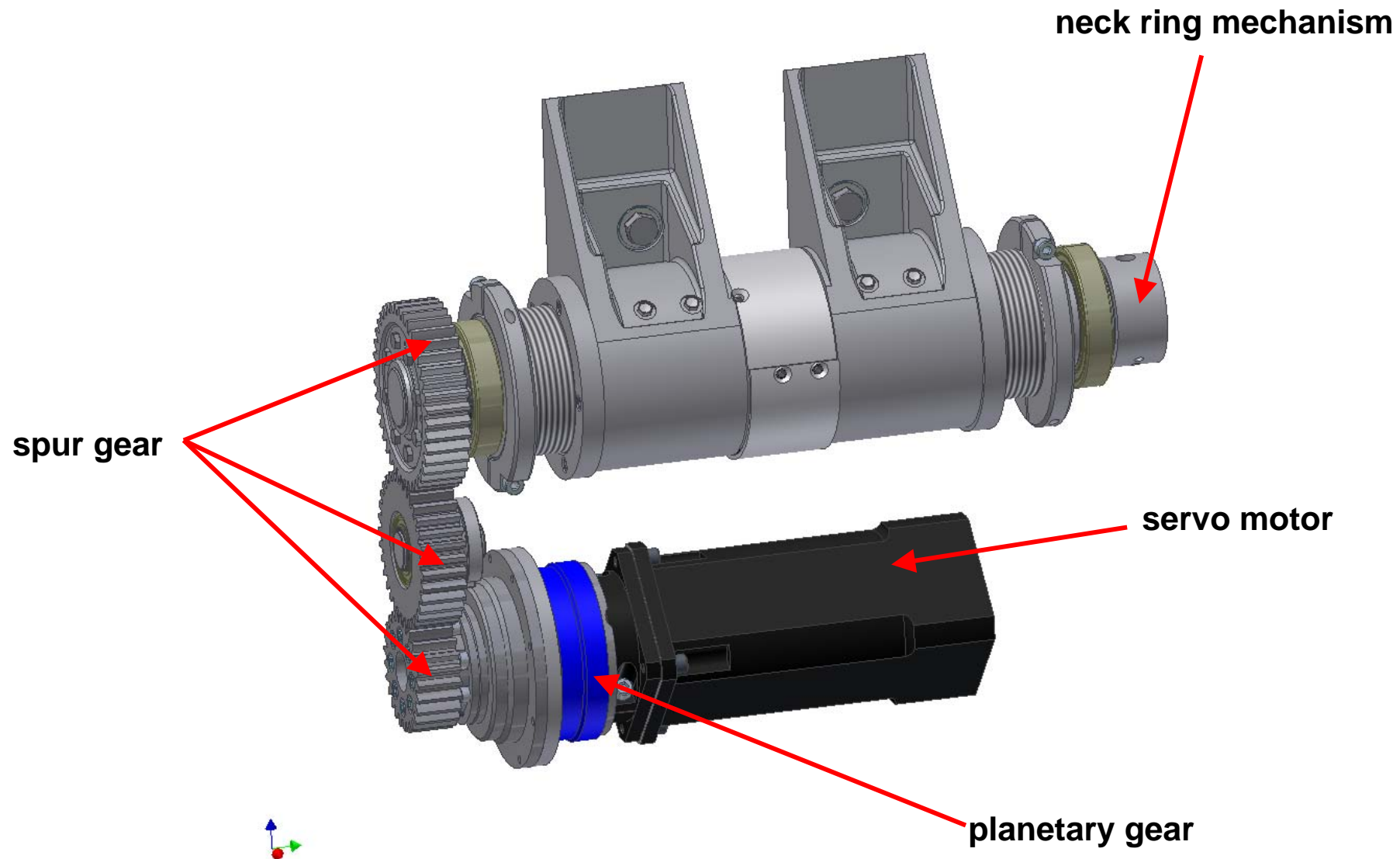

Take Out Mechanism, type 2332



Advantages

- Preselectable motion profile
- Preselectable motion time
- Programmable gripping and dead plate position
- Single, double and triple gob operation
- Conventional take out arms and take out tongs can be used
- Parameter setting via dialog

Take Out Mechanism, type 2332

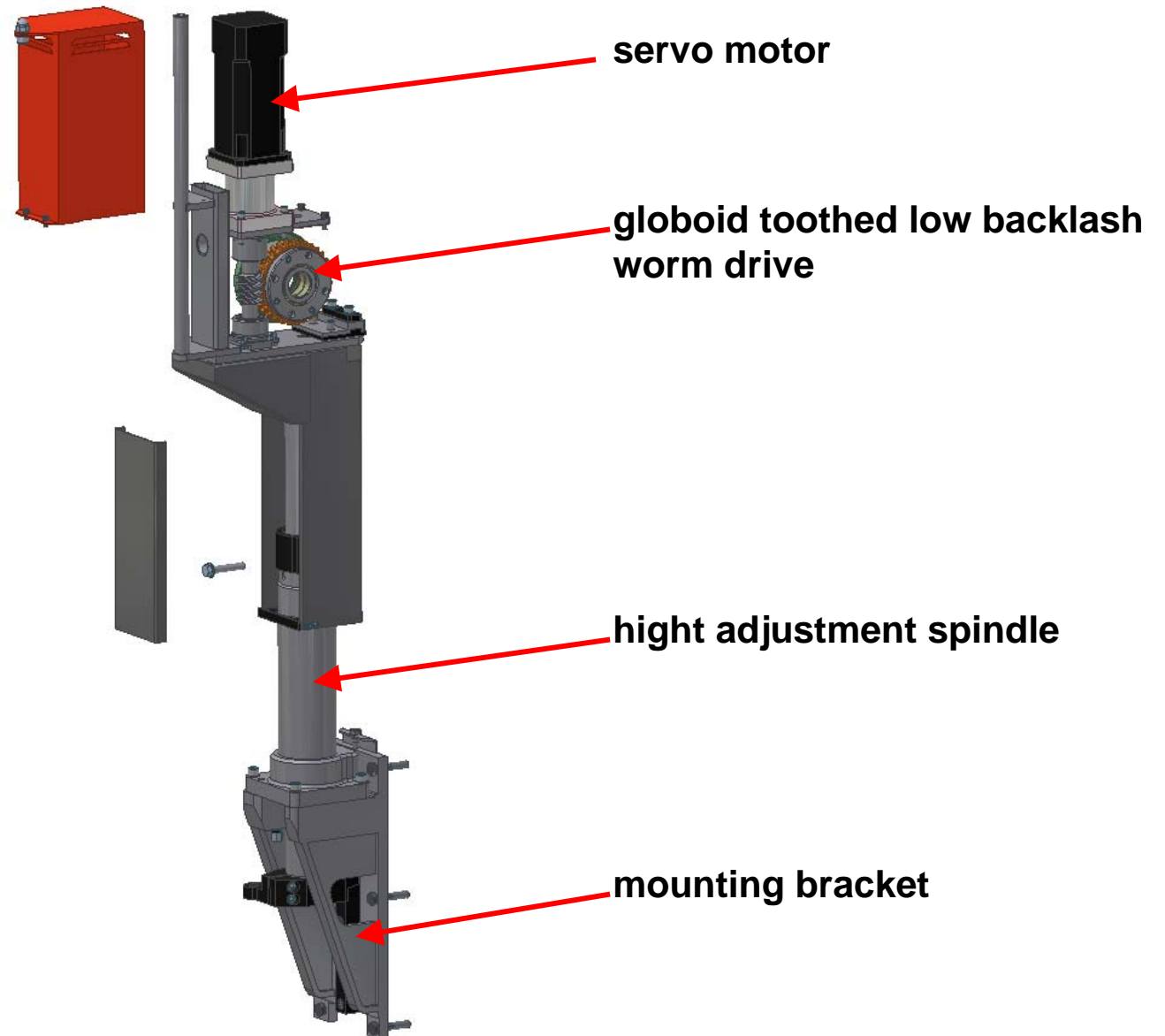

Servo E-Pusher, type 2155

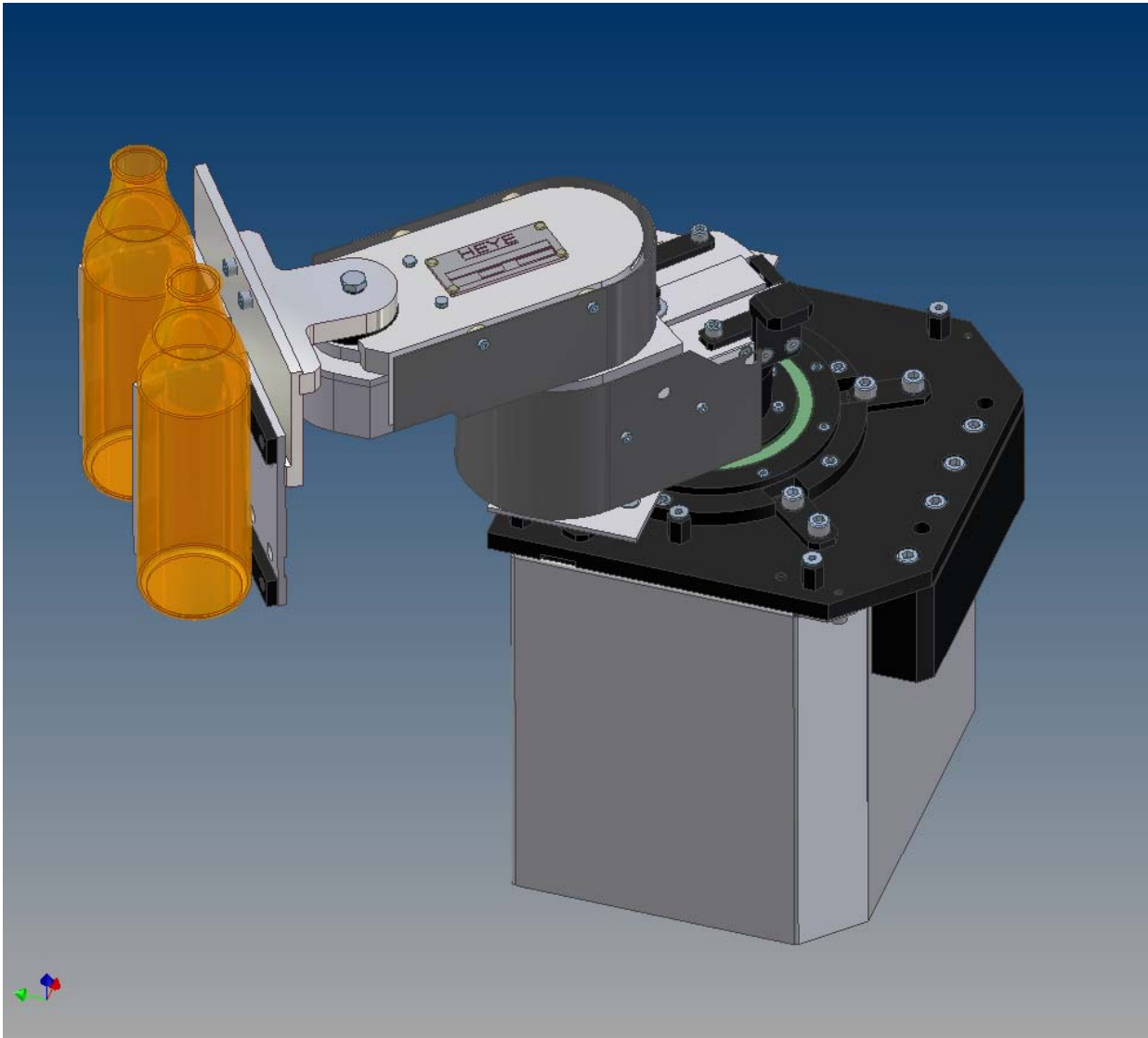

Advantages

- Fully servo motor driven
- No compressed air
- Up to 80 m conveyor speed
- Reproducible motion profile
- Service reduced operation

Servo E-Pusher, type 2155

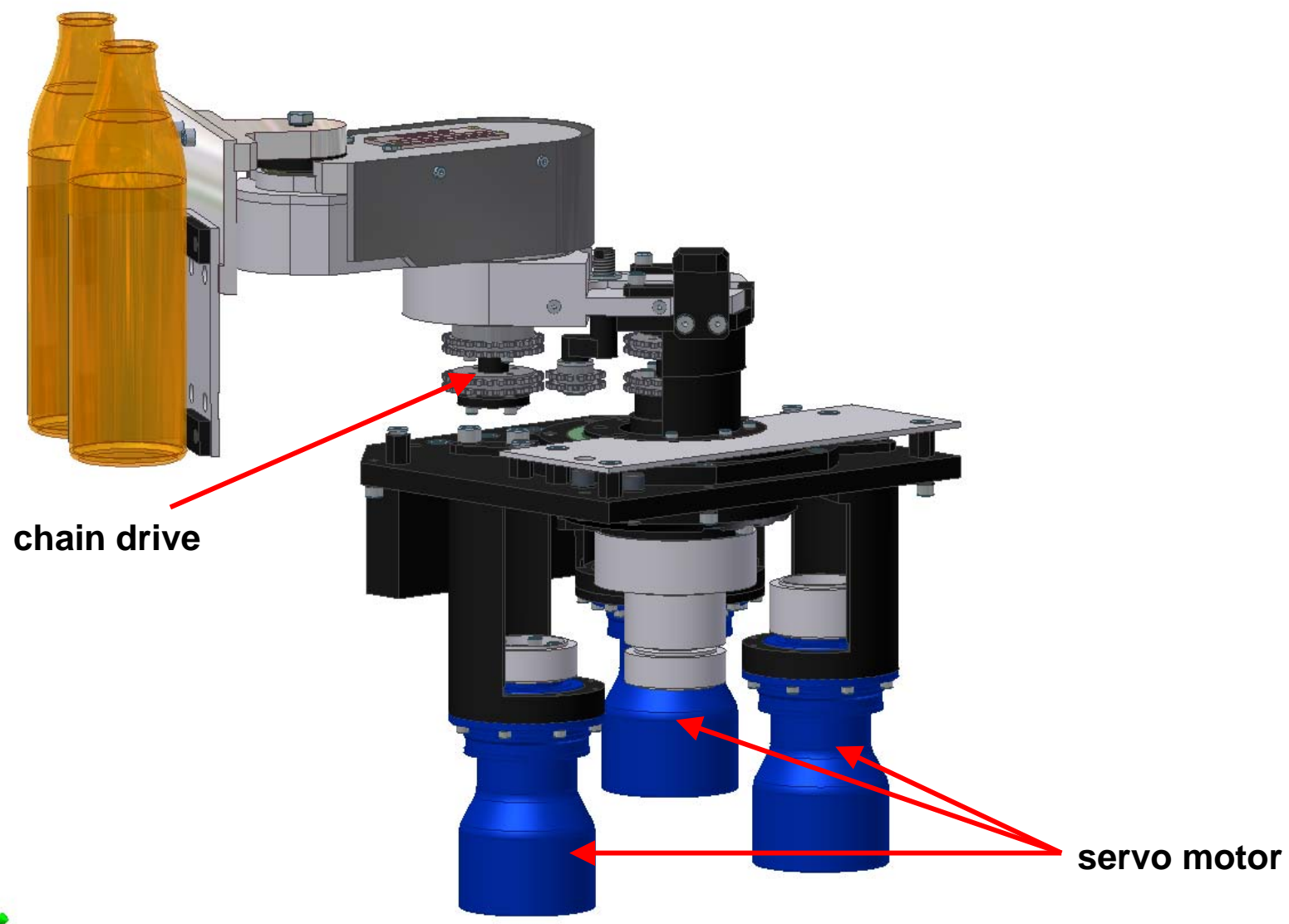

Servo Feeder mechanism, type Heye



Advantages

- Preselectable cam profiles
- Changeable cam profiles
- Preselectable plunger stroke
- Changeable plunger stroke
- Start / stop position selectable
- Up to 250 cuts per minute
- Maintenance free operation
- Parameter setting via dialog

Shear Mechanism, type 2323

Advantages

- Single, double, triple and quad gob operation
- Long operation time of the shear blades
- Long operation time of the shear mechanism
- Preselectable motion profile

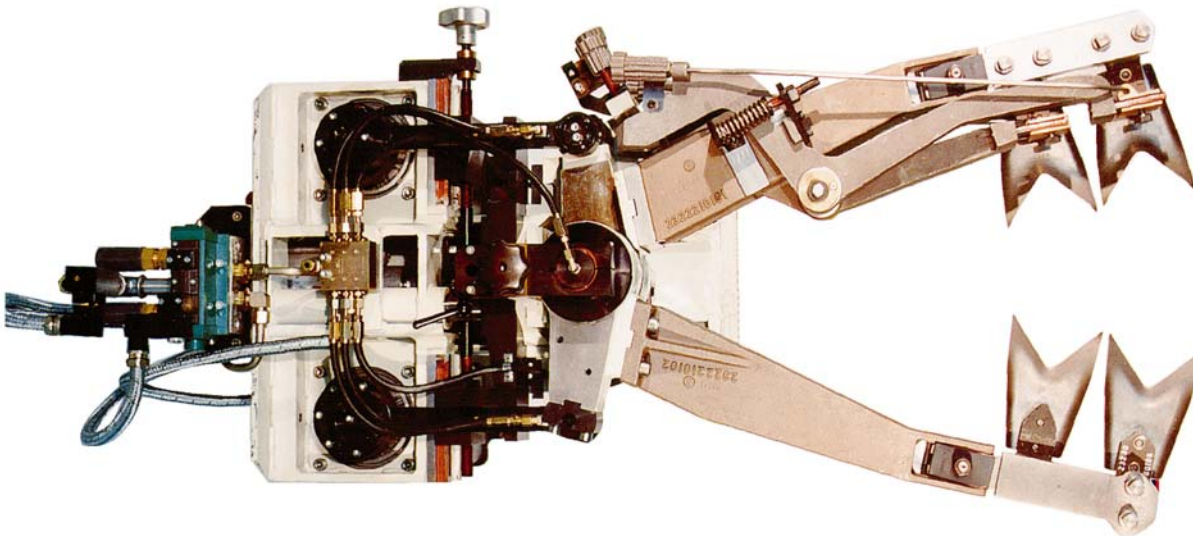

- Preselectable motion time
- Up to 250 cuts per minute
- Maintenance free operation
- Parameter setting via dialog

Servo Gob Distributor, type 2171

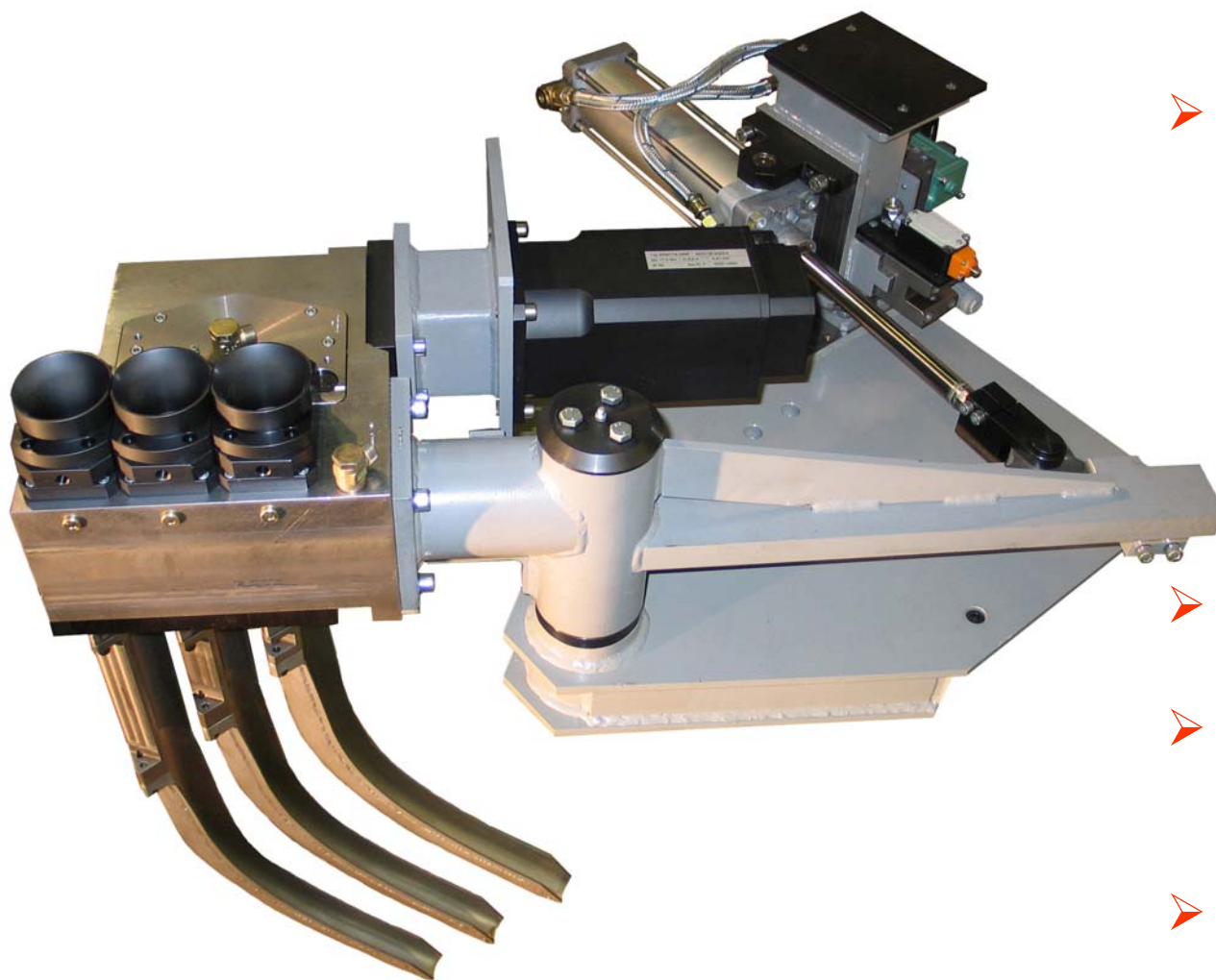

Advantages

➤ Modular System

	CD	Funnel dia.	
SG	-	76 mm	3"
DG	5"	76 mm	3"
DG	5"	62 mm	2,44"
DG	4 3/8"	62 mm	2,44"
TG	3"	47 mm	1,85"
QG	3"	47 mm	1,85"

- other CD available on request
- Scoop cooling integrated in distributor head
- up to 220 cuts per minute
- Exactly reproducible positioning